

THE BEST-SELLING
BLINDS BETWEEN GLASS
Now Available for Entry Doors

Light and Privacy Control

The perfect levels of light and privacy are yours to control. Our superior **EasyGlide System** allows our blinds to tilt completely closed, keeping you safe from prying eyes and unwanted light.

Easy to Operate

The ergonomically placed operator lets you raise, lower and tilt your blinds the entire length of the doorglass with only the slightest movement. No reaching or stooping is needed to adjust the blinds.

Low Maintenance

Since our blinds are enclosed between two panels of glass, you never need to dust which decreases allergens in your home. Blink Entry Doorglass carries a 20-year warranty on blinds, glass seal and operator for a long-term performance in your exterior door.

Safety

With no dangling cords, Blink Entry Doorglass is certified safe for children and pets. All of our enclosed blinds are offered in tempered safety glass.

Attention to Detail

We prioritized style and design by offering several colours and paid attention to aesthetic details, such as covering the cords with a bottom rail and matching all the visible components. Choose from an Evolve® or ZEEL® doorglass frame, and clear or Low-E glass.



Sizes	
IG Thickness	1"
Doorglass	20 x 36, 22 x 36, 20 x 64, 22 x 64, 20 x 80, 22 x 80
Doors	1.66" to 1.80" thick



TECHNICAL DRAWINGS & SPECIFICATIONS

(Drawings shown with Evolve Frame)

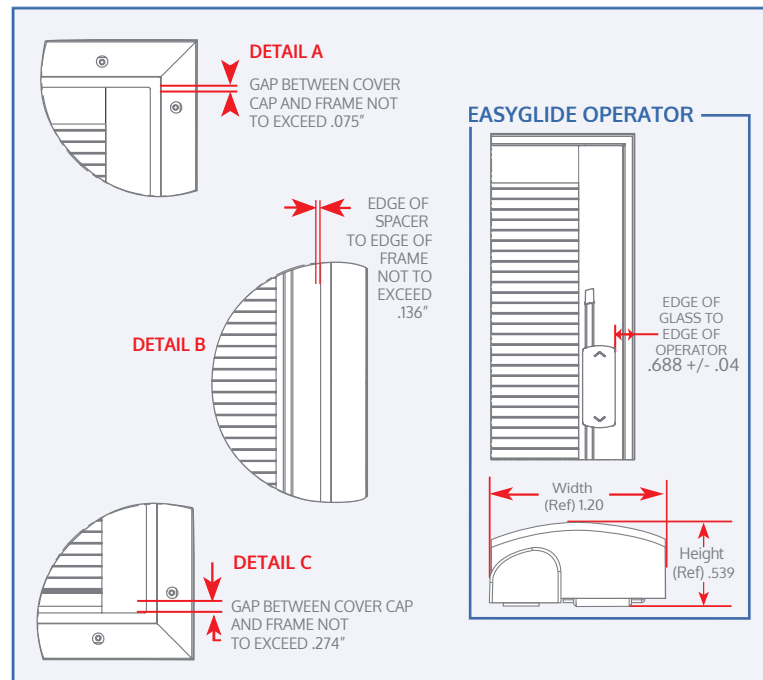
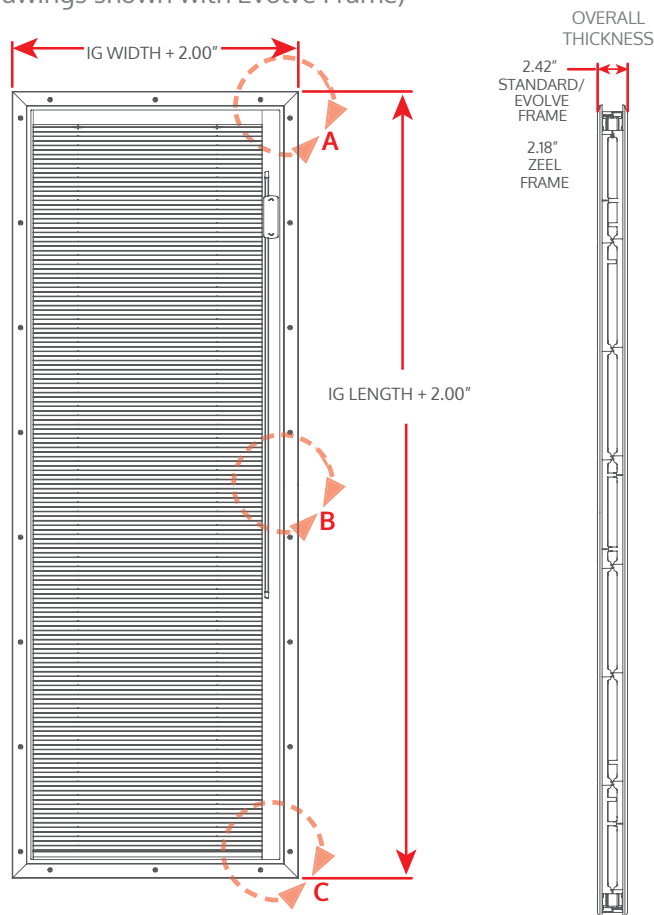

Materials

Spacer	Intercept®, tin plated steel
Glass (Clear or Low-E)	1/8" tempered safety glass
Single Low-E	2nd surface soft coat
ZEEL Frame	FiberMate Plus® white
Standard/Evolve Frame	FiberPro® oak & HP white
Blind Slat	12.5 mm wide aluminum UV stabilized coating
Sealant	Dual seal equivalent
Desiccant	Desiccant matrix (moisture & chemical management)
Decorative Cover Caps	UV stabilized, heat tolerant polymer

Maintenance

Glass	Clean with soap and water or quality window cleaner
Frame	Wash with soap and water

Warranty

20 year limited blind and glass seal warranty
Limited lifetime FiberPro® and HP frame warranty

Operation

Blind Function	Raise, Lower, and Tilt
EasyGlide Single Operator	Clear Overmold/Two Shot
Capillary Tube	Do not block, crush or cut
Operator Hand Position	Right-hand Only

Code of Compliance

IGCC (seal)	ASTM E2190 seal certification
ANSI (glass)	ANSI Z97.1 safety glazing (Applies to tempered glass only)
ASTM (glass)	ASTM C1036-16 flatness & C1048-18 tempered
ANSI (safety)	ANSI/WCMA A100.1-14
STC (doorglass)	STC 32
ENERGY STAR®	Can use in doors to meet ENERGY STAR® criteria